

Wall-mounted air intake/exhaust vent with wire mesh

# USAV/USAV-BM



## Description

USAV components can be used as air intake vents in an air supply system or air exhaust vents at the end of an air exhaust system for all types and modes of ventilation. The USAV air intake/exhaust vents feature on one side a 2x2 mesh of stainless steel wires having a diameter of 1 mm.



The USAV-BM grille has an insect mesh with a larger mesh size, i.e. 8x8 mm for diameters up to 125 mm, and 12x12 mm for diameters of 150 to 500 mm.

### Note:

When installing USAV air intake/exhaust vents on the outside, they must be protected against weather e.g. by coating them with paint in a colour matching the facade.

### Available materials - Product code examples

USAV -...- moulded aluminium and stainless steel mesh

### Product code example

Product code: **USAV - aaa**

type \_\_\_\_\_  
 Ød \_\_\_\_\_

## Dimensions

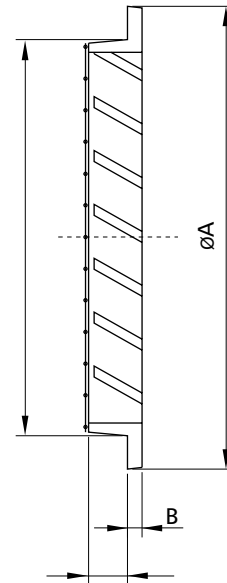

Ød [mm]	ØA [mm]	B [mm]	C [mm]	F [m <sup>2</sup> ]	Weight [kg]
80	100	5,0	15	0,0035	0,14
100	125	5,0	15	0,0044	0,16
125	150	5,0	15	0,0068	0,27
150	175	5,0	15	0,0098	0,32
160	185	5,0	15	0,0120	0,37
200	225	5,0	15	0,0200	0,65
250	275	5,0	15	0,0310	1,12
315	350	7,0	15	0,0470	1,90
400	430	1,0	50	0,0750	3,00
500	530	1,0	50	0,1180	5,50

# Wall-mounted air intake/exhaust vent with wire mesh

## USAV/USAV-BM

### Technical specifications

#### Performance

The chart shows the total pressure,  $P_t$  (Pa) and the sound level,  $L_w$  (dB(A)) vs. the volumetric air flow,  $q$  (l/s, m<sup>3</sup>/h).

#### Open space sound level

The chart shows the sound level,  $L_w$ .

Sound level at distance  $x$  (m).

$LA = L_w - K$ , see the table

