

Plenum boxes FLX-PRO-L...

[Download Wentyle](#)
[Download AlnorCAM](#)
[Buy via B2B](#)



Description

FLX-PRO-L plenum boxes are connecting pieces for FLX-HDPE and FLX-HDPE-A flexible ducts, which form a distribution system for mechanical installations, including recuperator systems. Due to small size, they do not require a lot of space or special installation.

This allows to save more usable interior space.

FLX-PRO-L plenum boxes are made of galvanized steel.

On special request, it is possible to make the plenum boxes using stainless steel.

It is possible to order insulated FLX-PRI-L plenum boxes. Plenum boxes are inside insulated with technical insulation with thickness of 9mm. Weldings are made outside the plenum boxes. To preserve the tightness class C it is recommended to use gasket FLX-USZ or FLX-USC.

Note:

Standard diameter d_1 is made as nippel. On special request diameter d_1 can be made as female dimension. For this purpose it must be aded "F" at the end to the index.

Example

Product code **FLX-PRO-L - 75 - 2**

type _____
 diameter _____
 connection points _____
 type of connection
 male
 F - female _____

Dimensions

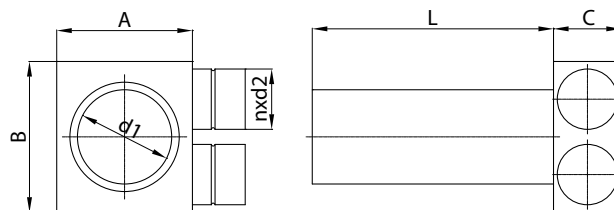

code	A [mm]	B [mm]	C [mm]	L [mm]	d1 [mm]	n [szt.]	d2 [mm]
FLX-PRO-L-63-2	180	180	75	320	125	2	63
FLX-PRO-L-63-3	180	270	75	320	125	3	63
FLX-PRO-L-75-2	180	200	90	320	125	2	75
FLX-PRO-L-75-3	180	300	90	320	125	3	75
FLX-PRO-L-90-2	200	240	110	320	125	2	90
FLX-PRO-L-90-3	200	360	110	320	125	3	90