

Shutoff dampers FLX-DAS...

[Download Wentyle](#)
[Download AlnorCAM](#)
[Buy via B2B](#)



Description

FLX-DAS damper may be used wherever a tight seal is not required.

Its main function is to adjust the air flow. Damper adjustment angle range is 90°. FLX-DAS dampers are made of galvanized steel.

On special request, it is possible to make the plenum boxes using stainless steel.

Example

Product code: **FLX-DAS - 75**

type

diameter

--	--

Dimensions

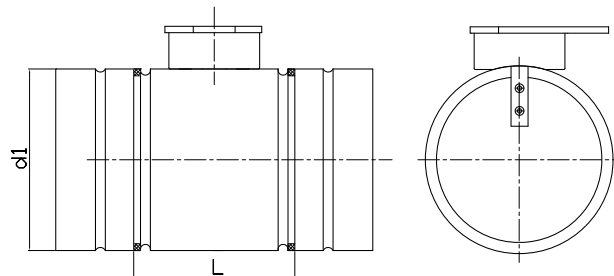

code	d1 [mm]	L [mm]
FLX-DAS-75	75	110
FLX-DAS-90	90	110